



# Offshore Capabilities 2023

GGC Cranes, Rigging and Scaffolding would like to acknowledge the traditional owners of the land and sea, we work on.

We pay our respects to the elder's past, present and emerging.



# About Us

---



Introduction

Offshore

Offshore  
Projects

Project  
Vessels

Mechanical  
Services

Safety Systems  
ISO 9001

Scaffold  
Tracking and  
Inspection

Employee  
Training

Design and  
Engineering

Scaffolding  
and Rigging

Contract  
Management

ISO Accredited

---

## Environmental Impact

THE GGC team is committed to engineering systems designed to increase productivity and minimise operating costs while reducing your environmental impact.





# Introduction

GGC is a specialist industrial and commercial rigging and scaffolding contractor.

We are the industry leaders in innovative design, engineering and execution of complex rigging and scaffolding.

The core of our business is our people. GGC has an experienced team of operators, advanced rigging, and advanced scaffolding professionals that can bring our vision and designs to life. Our safety culture and core values underpin our continued safety and success.



## Safety, Quality, Reliability, Accountability, Integrity and Respect.

We strive to ensure our clients achieve their deadlines on time, within budget, and incident-free.

### Key Capabilities

- Industrial construction and maintenance
- WEB Access Systems Installation
- Bridge Infrastructure
- Offshore and onshore Oil and Gas
- Commercial Construction
- Defence –Wharf and Fuel tank access
- Mining Construction and maintenance
- Demolition
- Major Infrastructure
- Rail Infrastructure





# Offshore Experience

GGC is a specialist industrial and commercial rigging and scaffolding contractor.

We are the industry leaders in innovative design, engineering and execution of complex rigging and scaffolding.

The core of our business is our people. GGC has a very experienced offshore team. From advanced rigging to specialised scaffolding access systems. Sixty per cent of our riggers and scaffolders have worked on the largest offshore projects in Australasia. The sample below is a snapshot.

- Kipper Tuna Turrum

Marlin A

Marlin B - Jacket Installation KTT-DB30

Marlin B – Stabbing Piles KTT-DB30

Marlin B – Top Side Prep

West Tuna R.A.T installation



## Offshore Experience - Construction

- Thylacine Topside and Jacket Installation – PPB and Southern Ocean - Technip FMC
- Kipper Tuna Turrum Project – DB 30 – McDermott - Bass strait
- Marlin B Installation - DB30 – McDermott - Bass Strait
- West Tuna RAT – Installation - DB30 – McDermott - Bass Strait
- Wheatstone beach pull and pipe lay – DB30 McDermott - Onslow WA
- Wheatstone subsea scope - flowlines, manifolds, risers - NO102, NO105 - McDermott
- Wheatstone tie-ins – DB30 – McDermott - Onslow WA
- Gorgon offshore pipelines and subsea assets - Solitaire - All Seas – WA
- Julimar project – Auddacia / Togmore - All Seas
- Inpex beach pull, shallow water scope - SEAMAC 1 - Saipem
- Inpex pipe lay and subsea assets - Castorone - Saipem
- Inpex subsea assets - Kuiper - various vessels



## Offshore Experience - Maintenance

- Rate reductions – Bayu Undan platform (Turn around maintenance)
- FSO – Conoco Phillips/Santos
- OKHA – FPSO – Woodside
- Blacktip (ENI Australia) – Maintenance shutdown







# Safety Management Systems ISO 9001:2015

GGC Rigging and Scaffolding is dedicated to a zero-harm workplace. GGC has a detailed safety management plan and a suite of policies and procedures that form part of our company induction process. We strive for continuous improvement, and our safety culture and core values underpin our continued safety and success. Our ISO-accredited systems cover the following.

- Site Inductions
- GGC company inductions
- Verification of Competencies
- JHA's / SWMS
- Take 5's carried out before commencing tasks
- Management and employee KPIs
- Occupational Health and Safety Act 2004
- Occupational Health and Safety Regulations 2017
- Safe Work Australia (2011) – Code of Practice: Managing the work environment and facilities
- Safe Work Australia (2011) – Code of Practice: How to manage work, health, and safety risks
- Safe Work Australia (2011) – Code of Practice: Hazardous manual tasks
- Safe Work Australia (2011) – Code of Practice: Managing the risk of falls in the workplace
- AS/NZS 4576: Guidelines for Scaffolding, AS/NZS 1576 parts 1-4 Scaffolding, AS/NZS 49994 Temporary edge protection
- Work safe Victoria (2008) Compliance code: prevention of falls in General Construction
- AS/NZS2550 Cranes, safe use parts 1 through 10 - General requirements
- AS/NZS 1418 (2021) Cranes, hoists and winches
- AS/NZS 1353.2 (1997) Synthetic – webbing slings, care and use
- AS/NZS 3775.1 (2014) Chain slings for lifting purposes
- AS/NZS 4497 (2018) Round slings - synthetic fibre



# Scaffold Inspection and Tracking



GGC has developed a central operating system we call “The Hub.” The Hub was designed and built locally, specifically for GGC. Our digital cloud-based scaffold register is part of the operating system.

Each scaffold will be entered into the hub with the required information, and a scaffold tag number will be generated. Once a platform has been erected and tagged, a GGC representative will issue the client a handover certificate.

The digital register will be updated with the information as per the handover certificate. When a scaffold is within two days of it requiring inspection, a reminder is automatically generated and sent to our HSEQ Manager for action. The scaffold inspection is done via tablet. Our tablets contain a digital inspection form that uploads and updates the scaffold register with the required information. We are integrating QR codes into the system for intelligent scaff tags. This QR code will generate site maps with GPS coordinates, including visuals of where on-site scaffolds are located.





## Personnel Qualifications and Training

All GGC personnel are highly trained, highly skilled construction professionals. All qualifications and training records are kept on file. We can make all documentation available for review and submit it to our clients as required. We support the development of our staff and encourage up-skilling and any additional training.

All staff have current high-risk tickets and nationally accredited working at heights certificates. Our offshore team has current BOSIET, CA-EBS, MSIC and CSTP tickets.

All GGC employees comply with CHO orders and are fully vaccinated.

GGC employees are drug screened and perform a GGC company induction before commencing work on-site. Verification of competencies is performed for all high-risk applications. GGC has an in-house verification of competency system for all our employee's high-risk licenses. This ensures our clients know they are getting skilled operators on their sites.

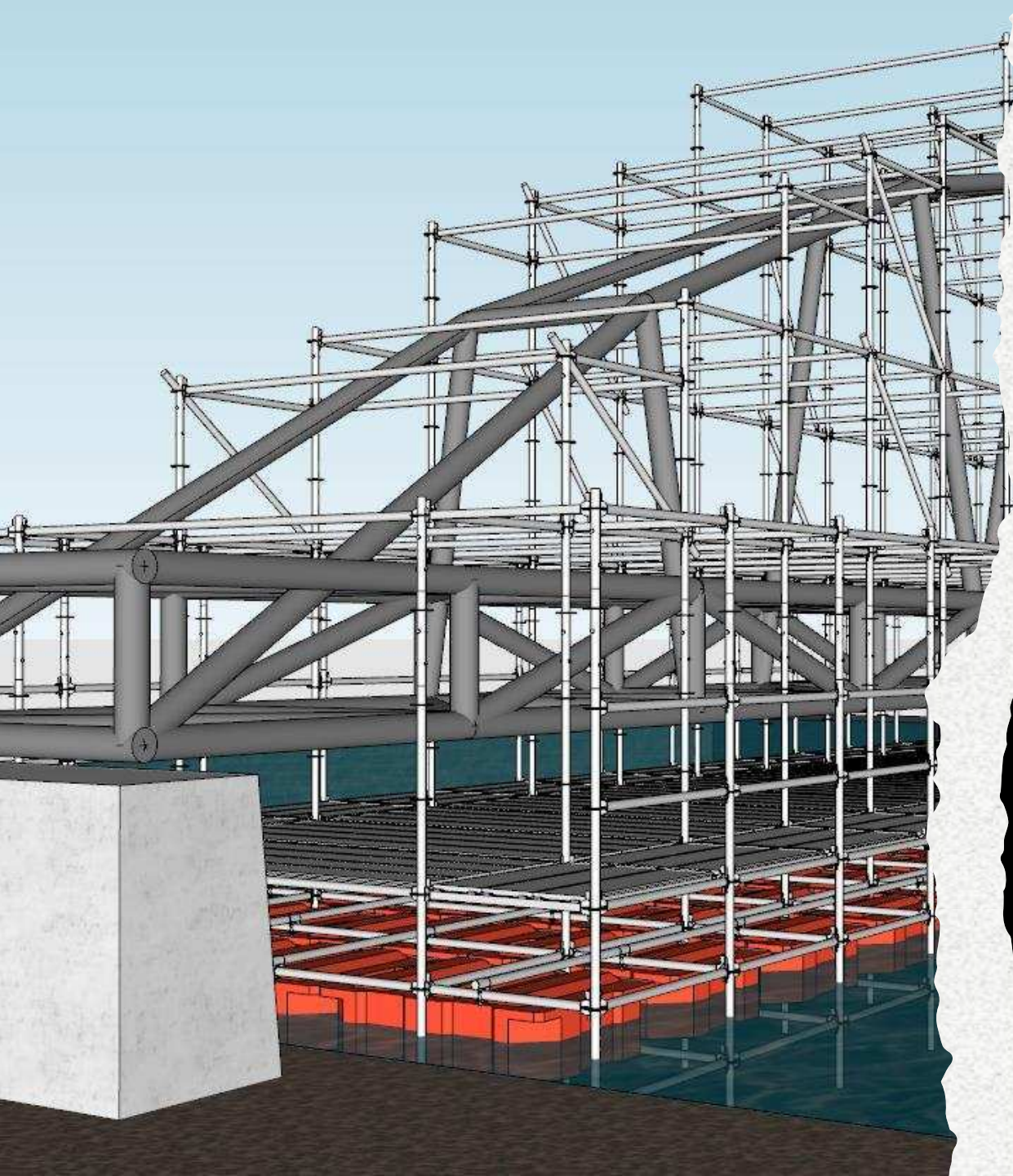

## Design and Engineering Services

GGC uses the most advanced scaffold design and engineering software in the world.

GGC has an in-house design and engineering department that produces innovative and detailed 2D designs, 3D renders and virtual reality presentations of our scaffolds. The detailed drawings give our on-site workforce clear and concise information to follow for the erection of the platform.

This process allows us to show our clients exactly what we intend to build before mobilising. This creates the opportunity for discussion and the ability to identify problems before they arise, such as clash points or access issues. We can generate a detailed and accurate equipment list from the software, which saves time on transport and labour.

Our process for the scaffold is as follows;

- Project brief considering the end-user requirements, structural load limitations, wind loading, etc.
- Concept designs generated for discussion and review in 2D, 3D and virtual reality.
- Draft Drawings generated with design and engineering reviews.
- Construction drawings and engineering certification.
- Picking lists generated, scaffold and crew mobilised to site.
- GGC Advanced scaffolders bring the designs to life with the on-site erection as per engineered drawings.

This process guarantees that the scaffold erected is compliant to;

- **AS/NZS 1576**
- **AS/NZS 4576**



# Scaffolding and Rigging Services



GGC Rigging and Scaffolding is a specialist Industrial and commercial rigging and scaffolding contractor. We are the industry leaders in innovative design, engineering, and complex rigging and scaffolding execution. We have built our reputation on delivering projects in some of the most remote parts of Australia. Our dual-ticked, multi-disciplinary team can provide projects with fewer staff on-site, saving time and money for our clients.

We love a challenge and specialise in integrated rigging and scaffolding systems, utilising our team's vast knowledge and experience. We strive to supply our clients with the safest, most innovative, and most efficient access solutions on Australia-wide projects.

- **Our access division offers the following services;**
- Advanced scaffolders
- Advanced riggers
- Bosiet Inducted
- Dual ticketed advanced rigger / advanced scaffolders
- 2D, 3D and virtual reality scaffold drawings and engineering
- Lift plan design and signoff for multiple chain block rigging operations
- Electric, synchronised multiple chain block solutions
- Modular barges and workboats to support marine, onshore and offshore projects





# GGC Crane Hire



Our priority is to provide a quality end to service for our clients. This is achieved by combining our workforce, plant and equipment. This provides a succinct streamlined outcome for all stakeholders involved.

## Our crane division services include

- Crane specialists
- Long-term project hire services
- Safety Inspections
- Crane maintenance
- Crane major inspections
- Mobilisation and de-mobilisation of cranes
- Transportation
- Lifting and rigging equipment
- Winches and rigging
- Project management
- Engineered Lift Plans
- Project brief considering the weight of the load to be lifted, the centre of gravity, the shape of the load.
- Site considerations include terrain, access and space available, import maps and build objects.
- Determine the best crane(s) for the application.
- Generate draft lift plans and methodology, crane positioning etc.
- Review with the clients, engineers and site team.
- Lift plans and methodologies signed off by GGC engineers.
- Mobilise cranes and rigging equipment for the project.
- Execute lift safely and efficiently.

**FRANNA**  
A TEREX BRAND

**CraneSafe**  
Div of The Crane Industry Council of Australia  
ABN 13 923 543 773

**ARTICULATED MOBILE CRANE**  
Annual Report

**Company:** Empire Cranes Pty Ltd  
**Address:** Suite 12 Level One 43 Victor Cres  
**State:** VIC  
**Postcode:** 3800

**ABN:** 26 621 987 773  
**Representative:** Jerald McDonald  
**Phone:** 0457 892543  
**Email:** jmc@empirecranes.com.au

**Make:** Puma  
**Model:** MAC 25  
**Serial Number:** 23023  
**Plant Number:** NOT APPLICABLE  
**Year of Manufacture:** 2013  
**Design Registration Number:** Q50539  
**Plant Registration:** NOT REQUIRED IN VIC  
**State Registration:** 174 16  
**Max Load:** 20000kg  
**Number of Axes:** 3  
**Lower Height:** 5721  
**Wheelbase:** 33678

**Country where Assessed:** Australia  
**Operators Manual in English:** OK  
**Log Book:** OK  
**Maintenance Records:** AS REQUIRED  
**Crane Safety Manual:** N/A

**Assessed By:** Terry Cameron  
**Reg. No:** VIC21319  
**Phone:** 0427 331 475  
**Email:** terry@terenceworks.net.au

**Company:** Terenceworks  
**Address:** 375 Sidney Road ARMIDALE  
**State:** NSW  
**Postcode:** 2351

**Initial Inspection Date:** 13/08/2020  
**Re-inspection Date:** 03/08/2022

**Issued Date:** 04/09/2020  
**Expiry Date:** 03/09/2021

**Confirms to Checklist Yes**

This report is a confirmation that the crane has undergone an annual inspection to the appropriate standard and is considered safe for continued operation at time of inspection.

**Actions Required - Nil**

Page 1 of 2





# Encapsulation



GGC provides a full suite of encapsulation options. Not only can we erect your scaffold, but we can wrap it in a variety of materials specific to your needs.

- Dehumidification reasons (low air quality)
- Waterproofing
- Asbestos removal
- Contaminated materials, lead-based coatings
- Mobile site sheds
- Monarflex – Blast Clad
- Shrink wrap
- Shade cloth
- Branded options available





## Dehumidification Services Refrigeration



Refrigerant dehumidification units use refrigerant to cool coils below the dew point, and as air passes over the coils, moisture condenses out of the air. This dehumidifier can remove large amounts of water from the air in hot, humid climates and cool the inside of tanks, containments, and vessels to meet OSHA regulations.

Dehumidification Technologies, LP offers dehumidifiers with a fused disconnect and internal breakers to protect the equipment and power source from electrical surges and other instances that could potentially cause damage.

Refrigerant-style dehumidifiers include:

- Fused disconnect.
- Transition for supply ducting.
- Two bank heater systems to get extra heat from the unit.
- Caged skid with fork pockets.
- Lifting eyes on a skid.
- Individual switches for heaters, cooling compressors and blowers.
- 2" thick filters on return.
- Capable of return transitions for re-circulation.
- Six performance tests before releasing for all projects.





# Contract Management

GGC contract management personnel will be responsible for the following without limitation:

- Managing all on-site operations per GGC and our client's policies and standards.
- Ensuring a safe and efficient workplace and promoting GGC culture and core values.
- Managing and coordinating on-site staff to satisfy all operational requirements of the client.
- Recording, monitoring, analysing and reporting on the performance of GGC servicing the clients as required.
- Preparing reports as requested by the client on the service of the agreement by GGC Cranes, Rigging and Scaffolding.
- Adjusting timing and scope as requested by the client to service operational requirements.
- Projecting, analysing, and resolving problems with the services as they occur
- Continually reviewing and improving upon GGC delivering its services.
- Provide regular feedback to our clients through meetings and reports.
- Managing communication between all stakeholders.
- Maintain an Issues and resolutions log registering all issues and resolutions raised by either party to build and maintain a professional and mutually beneficial relationship between GGC and our clients.
- Attend any meeting as required by our clients.
- GGC Directors will have a hands-on approach to all major events and outages and provide an on-site presence.



**Geelong**

**Darwin**

**Adelaide**

**Brisbane**

**[www.ggcscaffolding.com.au](http://www.ggcscaffolding.com.au)**

